

LID SECTION A-A FRAME SECTION A-A

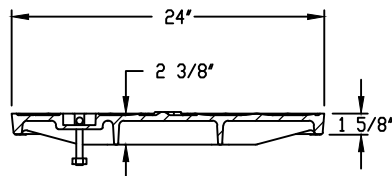

LID SECTION B-B

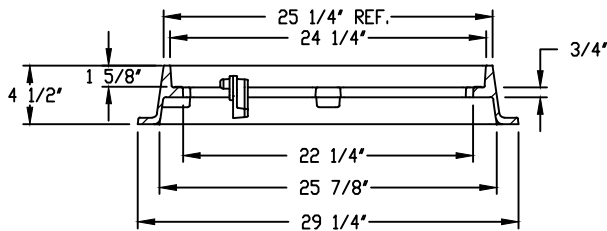

FRAME SECTION B-B

**NOTES:**

1. LOCKABLE FRAME TO BE EAST JORDAN PRODUCT #00777025B01 OR EQUIVALENT.
2. MATERIAL USED SHALL BE CAST IRON PER ASTM-A48, CLASS 35.
3. LID MUST BE SOLID, LOCKING, AND SHALL BE MARKED "DRAIN".
4. FRAME & LID SHALL ACCEPT TWO (2) 5/8" STAINLESS STEEL SOCKET HEAD CAP SCREWS
5. NONSLIP SOLID LID REQUIRED FOR CATCH BASINS WITHIN WALKING PATHS, TYP.

DRAWING NUMBER	U-STO-5
SCALE	NONE
REVISION DATE	6/24
DEPARTMENT	PW